



A10030X

Carabiners

⚠ WARNING: Compliant fall protection equipment must only be used as it was designed and adhere to the hierarchy of controls as discussed in ANSI Z359.2. Users **MUST** read and follow all user instructions provided with the product. Before using a fall arrest system, users must be trained in the safe use of the system, as required by OSHA 29 CFR 1910.30 and 1926.503, or local safety regulations. Misuse or failure to heed these warnings and instructions may result in injury or even death.

WORK SAFE! WORK SMART!

IMPORTANT

Before use, the user must read and understand these User Instructions. Keep these User Instructions for reference. If you have any questions about the proper use of the equipment, see your supervisor, user instructions, or contact Werner Co. for more information.

⚠ WARNING:

1. Failure to follow all instructions and limitations may result in serious personal injury or death.
2. Minors, pregnant women and anyone with a history of either back or neck problems should not use this equipment.
3. Do not use or install equipment without proper training from a "competent person" as defined by OSHA 29 CFR 1926.32(f).
4. Not all fall protection components are rated for the same user weight capacity. Only use components rated for the same weight capacity.
5. Caution must be taken when using carabiners and other fall protection equipment near moving machinery, electrical hazards, sharp edges, or abrasive surfaces. Contact with these elements may cause equipment failure, personal injury, or death.
6. Do not expose carabiners to chemicals or harsh solutions which may have a harmful effect.
7. Personal fall arrest systems, including carabiners, must be inspected prior to each use for wear, damage and other deterioration. Defective components must be immediately removed from service in accordance with the requirements of OSHA 29 CFR 1910.140 and 1926.502.
8. Striking objects horizontally due to the pendulum effect of a swing fall may cause serious injury or death.
9. Do not use if inspection reveals any defect, wear, damage, deterioration, inadequate maintenance, or unsafe condition. Do not use any equipment that has been subjected to the forces of arresting a fall or if any part of the carabiner is damaged or non-functional.
10. Only Werner Co., or persons or entities authorized by Werner Co., may make repairs or alterations to the equipment.
11. Alterations or misuse may result in serious personal injury or death.

PURPOSE

Carabiners are designed to be used as anchorage connectors or connectors for fall arrest, restraint, work positioning, suspension, or rescue systems.

USE INSTRUCTIONS

1. Before using a personal fall arrest system, employees must be trained in accordance with the requirements of OSHA 29 CFR 1910.30, 1926.503, or other requirements by a competent person as applicable in the safe use of the system and its components.

2. To connect the carabiner to the connection point, rotate the gate clockwise and push to the center of the carabiner. When positioned around a connection point, release the gate to close and lock.

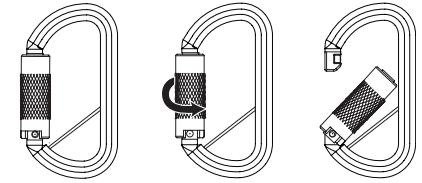

LOCKED

TWIST

UNLOCKED

3. Only use the carabiner when the gate can fully close and lock.
4. Only use the carabiner when it can be loaded lengthwise, along the spine of its long axis.
5. The A100301 and A100303 model carabiners are supplied with a roll pin that, when installed, provides a captive eye for connection of a component. To install the roll pin, drive the pin into the pre-drilled hole in the back bar of the carabiner using a punch. The open side of the roll pin should be facing away from the lanyard or lifeline material. Continue driving the pin through the back bar and into the front bar until the pin is flush on the outside of the back bar.

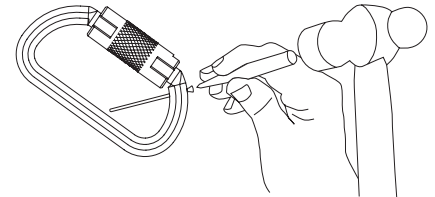

Model No.	Material	Length	Width	Gate Opening	Weight	Gate Strength	MBS	Compliance Standards
A100301	Zinc Plated Steel	4.1 in (104 mm)	2.3 in (58 mm)	0.75 in (19 mm)	0.5 lb (0.3 kg)	3,600 lbs (16 kN)	5,000 lbs (22.2 kN)	ANSI Z359.12-2019 OSHA 1910 & 1926
A100303	Zinc Plated Steel	9.3 in (236 mm)	5.2 in (132 mm)	2.1 in (53 mm)	1.8 lb (0.8 kg)	3,600 lbs (16 kN)	5,000 lbs (22.2 kN)	ANSI Z359.12-2019 OSHA 1910 & 1926
A100304	Aluminum	4.9 in (124 mm)	2.9 in (76 mm)	0.79 in (20 mm)	0.3 lb (0.1 kg)	3,600 lbs (16 kN)	5,000 lbs (22.2 kN)	ANSI Z359.12-2019 OSHA 1910 & 1926

User Instruction Manual



A10030X

Carabiners

USE LIMITATIONS

1. Carabiners must only be connected to compatible anchorages and other connecting equipment.
2. Carabiners must NOT be connected:
 - to a D-ring to which another connector is attached,
 - in a manner that would result in a load on the gate,

⚠ WARNING: If the connecting element that a carabiner attaches to is undersized or irregular in shape, a situation could occur where the connecting element applies a force to the gate of the carabiner. This force may cause the gate to open, allowing the carabiner to disengage from the connecting point.

- in a false engagement, where surrounding influences prevent the carabiner from fully closing and engaging the connection to each other,
- to any object which is shaped or dimensioned such that the carabiner will not close and lock, be loaded incorrectly, or that roll-out could occur.

⚠ WARNING: Large throat opening carabiners should not be connected to standard size D-rings or similar objects which will result in a load on the gate if the carabiner or D-ring twists or rotates. Large throat carabiners are designed for use with anchorages or other connectors that are shaped in a way that cannot pressure the gate.

3. Carabiners are designed to be used in temperatures ranging from -40°F to +130°F (-40°C to +54°C). Carabiners are designed to be used for personal protection and not used to hoist materials or other purposes.

PROPER CONNECTION

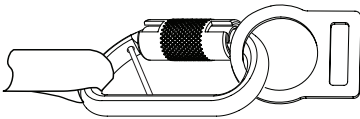

IMPROPER CONNECTIONS

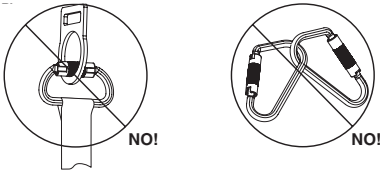

INSPECTION

Carabiners shall be inspected before each use and annually by a competent person other than the user. Local governmental jurisdictions may require more frequent inspections. If the carabiner has been subjected to forces of arresting a fall, is damaged or non-functional, or does not pass inspection, remove it from service immediately. To inspect a carabiner;

1. Inspect the body and gate of the carabiner for signs of deformity. If a carabiner body or gate is deformed, remove from service.
2. Inspect the body and gate for cracks, nicks, gouges, corrosion, chemical damage, paint, or debris. Remove damaged carabiners from service.
3. Inspect for smooth, proper operation of the gate. It must open, close, and lock smoothly and automatically. Remove from service if defective.
4. Inspect the locking barrel that it rotates and closes completely. Debris inside the gate can prevent the gate from locking completely.
5. If present, inspect the captive bar for signs of damage and that it still holds the connecting part. Deformed captive bars indicate improper loading, damage or modification. Remove from service if damaged.
6. Inspect that the carabiner markings are legible. If markings are illegible, remove from service.

MAINTENANCE AND STORAGE

Carabiners can be cleaned with a soft cloth to remove any contaminants. A dry lubricant can be used on the gate mechanism to lubricate the carabiner, providing lubricant does not contact any equipment the carabiner is connected to. The carabiner must be stored in a cool, dry place out of direct sunlight when not in use. Do not store where damage from environmental factors such as heat, light, excessive moisture, oil, chemicals or vapors, or other degrading elements exist. Do not store damaged or equipment in need of maintenance in the same area as products intended for use.

Other than cleaning and lubrication, do not attempt or conduct any maintenance on carabiners. Only Werner Co., or persons or entities authorized by Werner Co., may make repairs or alterations to the equipment.

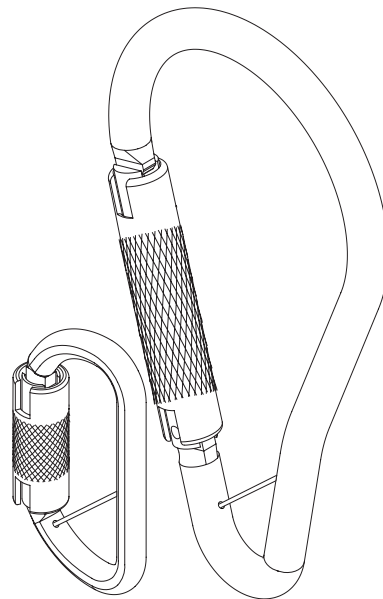

User Instruction Manual

WernerCo Corporate Headquarters: 555 Pierce Road, Suite 300, Itasca, IL 60143

TEL: 888-523-3370 FAX: (724) 588-0315 www.wernerco.com